

ITEM NO.	PART NUMBER	QTY.
1	14038	2
2	14124	5
3	17653	20
4	27322	1
5	50185-M	1
6	50181-M	2
7	50187-M	2
8	50183-M	2
9	49942	2
10	16086	2
11	14312	6
12	16530	2
13	49817	2
14	48511	4
15	50182-M	2
16	49904-M	2
17	50186-M	1
18	49614	1
19	48588-M	2
20	16101	2
21	49748	2
22	49749	2

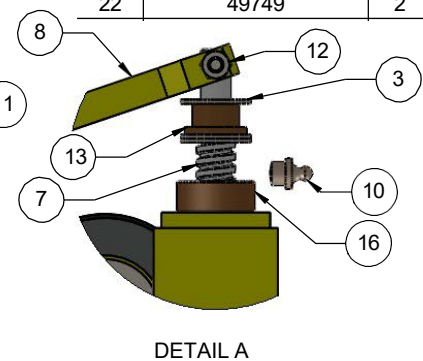

ECN	REV	DESCRIPTION	DRAWN	CHECKED	DATE	UNLESS OTHERWISE STATED	TOLERANCE UNLESS OTHERWISE SPECIFIED		PROPRIETARY AND CONFIDENTIAL	
-	A	RELEASED FOR MANUFACTURING				- ALL SHARP EDGES TO BE GROUND R0.125" - ALL WELDS IN ACCORDANCE WITH AWS D1.1 and KWS-001 - MARKSTAMP PT. # AND/OR W.O.# ON PARTS - CL ± 0.063	X" ± .5" X.X" ± .25" X.XX" ± .125" X.XXX" ± .063" X.XXXX" ± .010" X ± 1		THE INFORMATION CONTAINED IN THIS DRAWING IS THE SOLE PROPERTY OF MIE SUPPLY. ANY REPRODUCTION IN PART OR AS A WHOLE WITHOUT THE WRITTEN PERMISSION OF MIE SUPPLY WORKS IS PROHIBITED. TITLE: FRONT LANCE SUPPORT ASSEMBLY	
	B					MATERIAL	3rd ANGLE PROJECTION		M49836	
	C					N/A	CHECKED:		WT:50.161 LBS	
	D					COATING	APPROVED:	SHEET 1 OF 1		
	E					N/A		A		
						DO NOT SCALE ALL DIMENSION IN INCHES				
I		H	G	F	E	D	C	B	A	

001-101-005 REV A - C:\DOENGRYVAULT\Products\107 - Pipe Cleaning Machine\107 - Mechanical sub Assemblies